

Thread hose coupling

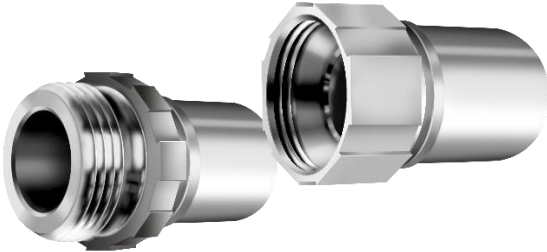

APPLICATIONS

Male and female threaded couplings for several industrial applications, e.g foodstuff, chemical and mining industries.

Coupling thread is according to EN ISO 228-1 / BSP. As default the hose shank is smooth, coupling material is acid proof steel AISI 316 / EN 1.4401. Female coupling seal material is PTFE. Serrated hose shank and other coupling/seal materials available.

Recommended clamps according to EN 14420-3.

ADVANTAGES

- Safe and durable

TECHNICAL PROPERTIES

Material

- Coupling:
 - stainless steel AISI 316 / EN 1.4401
 - other materials available, for example brass
- Seal:
 - PTFE
 - other materials available

SUITABLE HOSE CONNECTORS

- Safety clamp

SALES

Teknikum Oy (Business ID FI07645274),
Nokiankatu 1, 38210, Sastamala, Finland



More information

sales@teknikum.com

www.teknikum.com



ORDER REFERENCE

Product code FEMALE COUPLINGS 	Product code MALE COUPLINGS 	DN	Hose Ø i.d. mm 	Material
KFKARKAR013	KMKAR013	15	13	SS
KFKARKAR019	KMKAR019	20	19	SS
KFKARKAR025	KMKAR025	25	25	SS
KFKARKAR032	KMKAR032	32	32	SS
KFKARKAR038	KMKAR038	40	38	SS
KFKARKAR040	KMKAR040	40	40	SS
KFKARKAR050	KMKAR050	50	50	SS
KFKARKAR063	KMKAR063	65	63	SS
KFKARKAR065	KMKAR065	65	65	SS
KFKARKAR075	KMKAR075	80	75	SS
KFKARKAR050	KMKAR080	80	80	SS
KFKARKAR100	KMKAR100	100	100	SS