

## Teknikum® Rubber Lined STEEL T- AND X- BRANCHES 90°



### APPLICATIONS

Rubber lined steel pipes are the best choice for pipelines where a need of inflexibility and permanent load bearing capacity of a pipe is critical. Such pipeline sections are often found in slurry process flows of concentrating plants for areas of junction to pumps, technological equipment (mills, separators, flotation cells, thickeners, filters, cyclones, classifiers), process tanks, flows separation in mining, cement industry and coal industry.

Teknikum rubber lining provides long life and wear protection for the pipes, while ensuring maximum capacity of material handling.

### ADVANTAGES

- Great wear resistance of lining
- Very strong adhesion to steel
- Good strength values
- Low flow resistance
- Listed standard sizes and forms are available with quick delivery
- Retains the free flow area without turbulence at the couplings

- Pipe ends are vulcanized by rubber to eliminate leakages without the need of extra gaskets
- Delivery reliability – the used rubber compounds are developed and manufactured in-house by Teknikum

### CUSTOMIZED SOLUTIONS

- Customized configurations of pipes and branches as well as complex technical solution are made by order
- Wide range of customized arrangements, typical range from DN50 mm up to DN 400 mm.
- Rubber lining with intermediate wear indication red layer is possible for visual wear indication

### LINING RUBBER

#### Teknikum WEAR SAFE™ Black 40 or 60

Natural rubber and butadiene rubber mixture based on black soft rubber, which is highly resistant to various abrasive slurries. This proven compound is used in mining environment, seawater applications and various process industry applications.

The hardness 40 ShA is great for abrasion resistance supported by excellent resilience to stand flexible surface for material flow.

The hardness 60 ShA is great for tear resistance supported by excellent resilience to stand flexible surface for material flow.

Developed for the mining industry, e.g. material transfer at concentration plants and tailings pipelines.

Autoclave vulcanization.

*More details on compound datasheet.*

## Teknikum WEAR SAFE™ Red 40

Natural rubber and butadiene rubber mixture based on black soft rubber compound, which is highly resistant to various abrasive slurries used at mining environment and other process industry applications.

The hardness 40 ShA is great for abrasion resistance supported by excellent resilience to stand flexible surface for material flow.

Developed for the mining industry, e.g. material transfer at concentration plants and tailings pipelines. The red color allows use as visual wear indicator in case of two (2) layers of rubber lining is placed (black soft rubber lining on top).

Autoclave vulcanization.

*More details on compound datasheet.*

## TECHNICAL PROPERTIES

### Standard configuration includes:

- Flat flanges according to EN1092-1
- Steel: P235 JRG2
- Typical flange connection PN10
- Rubber lining elastomer:
  - Natural rubber and butadiene rubber (NR/BR)
  - Hardness 40 or 60 ShA
  - Color black (or red)
- Thickness of rubber lining:
  - 5 mm for pipes DN50-DN300, flanges 5mm
  - 10 mm from DN350 mm, flanges 5mm
- Body steel in accordance with P235TR1
- Surface treatment:
  - preparation grade Sa 2.5
  - painting system EP180/1
  - default color gray

- Mounting kit for flanges can be included into a scope
- Any other standards can be applied in the manufacturing according to customers' requirements

## QUALITY & COMPLIANCE

The manufacturing quality control is based on ISO-9001 certified systems.

Teknikum rubber compounds do not contain any RoHS 2 controlled substances or phthalates and are compliant with REACH directive.

The compounds do not contain any substances named on the SVHC (Substances of Very High Concern) candidate list XIV of REACH.

## MANUFACTURER

Teknikum Oy (Business ID FI07645274),  
Nokiankatu 1, 38210, Sastamala, Finland

### Sales & Marketing

Teknikum Group, Lining BU

### More information

[sales@teknikum.com](mailto:sales@teknikum.com)

[www.teknikum.com](http://www.teknikum.com)

All rights reserved. © 2022 Teknikum Group Ltd.



ORDER REFERENCE: **RUBBER LINED STEEL T-BRANCHES 90°**

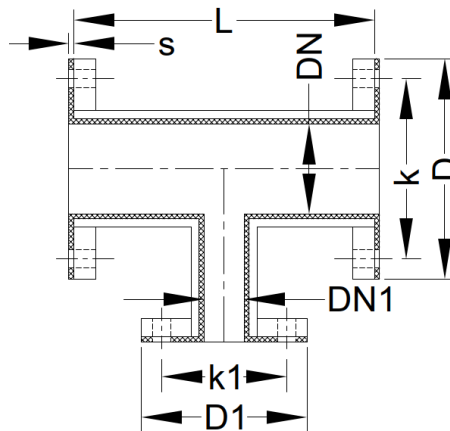

### Rubber Lined Steel T-branches 90°

Product code	DN	DN1	k	k1	D	D1	L	s
LRLT050-050	50	50	125	125	165	165	200	5
LRLT080-050	80	50	145	125	200	165	230	5
LRLT100-050	100	50	180	125	220	165	280	5
LRLT125-050	125	50	210	125	250	165	305	5
LRLT150-080	150	80	240	145	285	200	305	5
LRLT200-080	200	80	295	145	340	200	400	5
LRLT250-080	250	80	350	145	395	200	400	5
LRLT300-100	300	100	400	180	445	220	460	5
LRLT350-100	350	100	460	180	505	220	500	10/5
LRLT400-100	400	100	515	180	565	220	550	10/5

REFERENCE IMAGES



ORDER REFERENCE: **RUBBER LINED STEEL X-BRANCHES 90°**

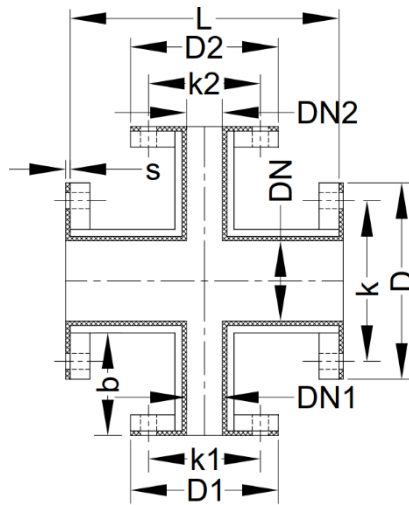

### Rubber Lined Steel X-branches 90°

Product code	DN	DN1	DN2	k	k1	k2	D	D1	D2	L	s
LRLX050-050-050	50	50	50	125	125	125	165	165	165	200	5
LRLX080-050-050	80	50	50	145	125	125	200	165	165	230	5
LRLX100-050-050	100	50	50	180	125	125	220	165	165	280	5
LRLX150-080-050	150	80	50	240	145	125	285	200	165	305	5
LRLX200-080-050	200	80	50	295	145	125	340	200	165	400	5
LRLX250-100-080	250	80	50	350	145	125	395	200	165	400	5
LRLX300-100-080	300	100	80	400	180	145	445	220	200	460	5
LRLX350-100-080	350	100	80	460	180	145	505	220	200	500	10/5
LRLX400-100-080	400	100	80	515	180	145	565	220	200	550	10/5

### REFERENCE IMAGES

