

TEKNIKUM® Steel Top Lifters

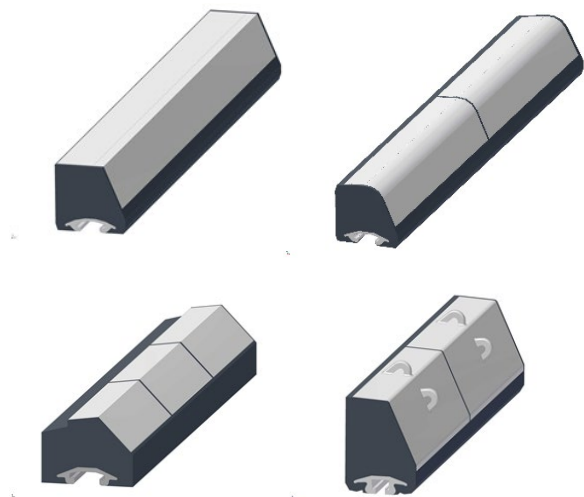

Teknikum® Steel Top Lifters give longer lifetime for mill linings in specific conditions: wear resistant steel top and elastic rubber body creates the combination, which is especially good in circumstances where lifter bars must take sharp hits of grinded mineral and media.

In places where steel is too hard and brittle, and rubber is too soft, steel coated rubber lifter bars provide the best solution. The steel on the top protects the rubber body, while the rubber body maintains the elasticity of lifter bar which protects the steel.

All lifter bars are moulded and tailor made for the customer mills and processes.

The quality of steel and model will be chosen for every purpose differently. Hardness and type of the steel must be chosen according to grinding and process parameters. In some applications lifters are accompanied with steel coated shell or head plates. These are available on request.

Steel Top lifters are part of Teknikum Steel Top Mill Lining Solution.

ADVANTAGES

- Longer lifetime for mill linings
- Excellent wear resistance
- Easy installation

TECHNICAL PROPERTIES

Rubber compound

The lifter bars are made of wear resistant Teknikum® TRL rubber compound depending on the application.

Steel

The quality of steel and model will be chosen for every purpose differently. Hardness and type of the steel must be chosen according to grinding and process parameters. Options are available from cast steel and wear resistant steel with different thickness and hardness options.

Fixing profile

Aluminum or steel fixing profile can be selected depending on the process. Fixing can be with clamp block or T-bolt depending of fixing profile.

Lifter versions

WS – Wear Resistant Steel Top lifters are for heavy / medium grinding processes. With wear resistant Steel Top. The thickness and hardness can be selected for every purpose process separately. Thickness of steel can vary 10 – 80mm.

CSL - Cast Steel Light lifters are for medium grinding processes. The cast steel top is lighter than in our other cast iron top lifters, which makes the installation and handling easier.

CSH - Cast Steel Heavy lifters for heavy / medium grinding processes. The cast steel

top is thick, and it can take heavy hits for example in a ball mill.

CSHD - Cast Steel Heavy Duty lifter for heavy grinding processes on primary mills. For the applications, where high cast Steel Top lifter bar is needed. The cast is thick and can take heavy hits.

COMPLIANCY

Suitable for:

- Overflow and grate discharge mills
- Mill shell lifters
- Mill Head lifters
- Primary / Secondary / Tertiary grinding

MANUFACTURER

Teknikum Oy (Business ID F107645274),
Nokiankatu 1, 38210, Sastamala, Finland

Sales

Teknikum Group, Lining BU

More information

sales@teknikum.com
www.teknikum.com

All rights reserved. © 2020 Teknikum Group Ltd.



ORDER REFERENCE

Other dimensions available on request.

Version	Width (mm)	Height (mm)	Max length (mm)	Fixing size
WS	125	100 - 150	1500	M16-M20
WS	140	85 - 140	1500	M16-M20
WS	150	100 - 150	1500	M16-M24
WS	165	100 - 180	1500	M16-M24
WS	200	125 - 400	1500	M24-M36
WS	210	210 - 400	1500	M24-M36
WS	245	125 - 400	1500	M24-M36
CSL	140	140	1500	M16-M20
CSL	150	150	1500	M16-M20
CSL	165	155	1500	M16-M24
CSL	210	275	1500	M24-M30
CSH	210	153	1320	M24-M30
CSH	210	133	1320	M24-M30
CSH	250	225	1320	M24-M36
CSHD	210	275	1500	M24-M36

REFERENCE IMAGES



WS - Wear Resistant Steel Top



CSL - Cast Steel Light



CSH - Cast Steel Heavy

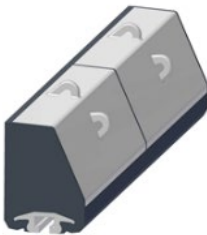

CSHD - Cast Steel Heavy Duty



Steel Top Lifters for overflow and grate discharge mill shell and head lifters