

Teknikum® Straight Connecting hose



APPLICATIONS

Teknikum Connection hoses are used to absorb vibrations in the pipeline and transportation of abrasive material. Hose is suitable for many circumstances where the hose must resist wear, movements, vibrations and heat expansions.

The hose is made with rubber flanges and uses steel support flanges. Available also with other connector systems according to the applications and conditions. Please check the suitable couplings and flanges options below.

Available in a wide range of customized dimensions and rubber materials (SBR, NBR or EPDM rubber) and for extremely abrasive solutions with CERAMIC inner lining* (*only with PLUS™ connection).

NR rubber hose has antistatic properties, providing electrical conductivity and increased safety against ESD.

Teknikum hoses can also be made of EPDM (chemical resistant) or NBR (oil resistant) rubber materials.

ADVANTAGES

- Vacuum (S) and delivery (D) versions available
- Safe and durable material handling hose
- Excellent resistance to abrasion and weather
- Eliminates vibrations and noise
- ESD protection with Antistatic version
- EPDM and NBR material options
- Quick and easy installation
- Optionally with TITAN™ Select couplings or PLUS™ flanges

TECHNICAL PROPERTIES

Structure

- Tube: black NR 43 ShA
 - smooth
 - wear resistant
 - antistatic
- Reinforcement
 - textile and steel spiral* (*only in SD version)
- Cover: black SBR 60 ShA
 - wear and weather resistant
 - antistatic
- Burst safety factor 2 x working press.

Temperature range

- NR / SBR -40°C - +80°C.
- NBR -40°C - +90°C.
- EPDM -40°C - +100°C.

Electrical properties

Teknikum TITAN™ (NR):

- Conductive cover $R \leq 10^6 \Omega$ / length
- Conductive through the hose wall $R \leq 10^9 \Omega$

SUITABLE COUPLINGS AND FLANGES

Standard hose is made with Teknikum® Flange connection. Supporting flanges or drilling are not included in product prices.

See connecting versions details in:

- **Teknikum® Flange** datasheet.
- **Teknikum® PLUS™ flange** datasheet.
- **Teknikum® TITAN™ Select** datasheet

Optionally we recommend Teknikum PLUS™ flange system, or with Teknikum® TITAN™ Select couplings and Select gaskets.

3D-model library for connecting hoses

www.teknikum.com/3D

MANUFACTURER

Teknikum Oy (Business ID FI07645274),
Nokiankatu 1, 38210, Sastamala, Finland

More information

sales@teknikum.com







www.teknikum.com

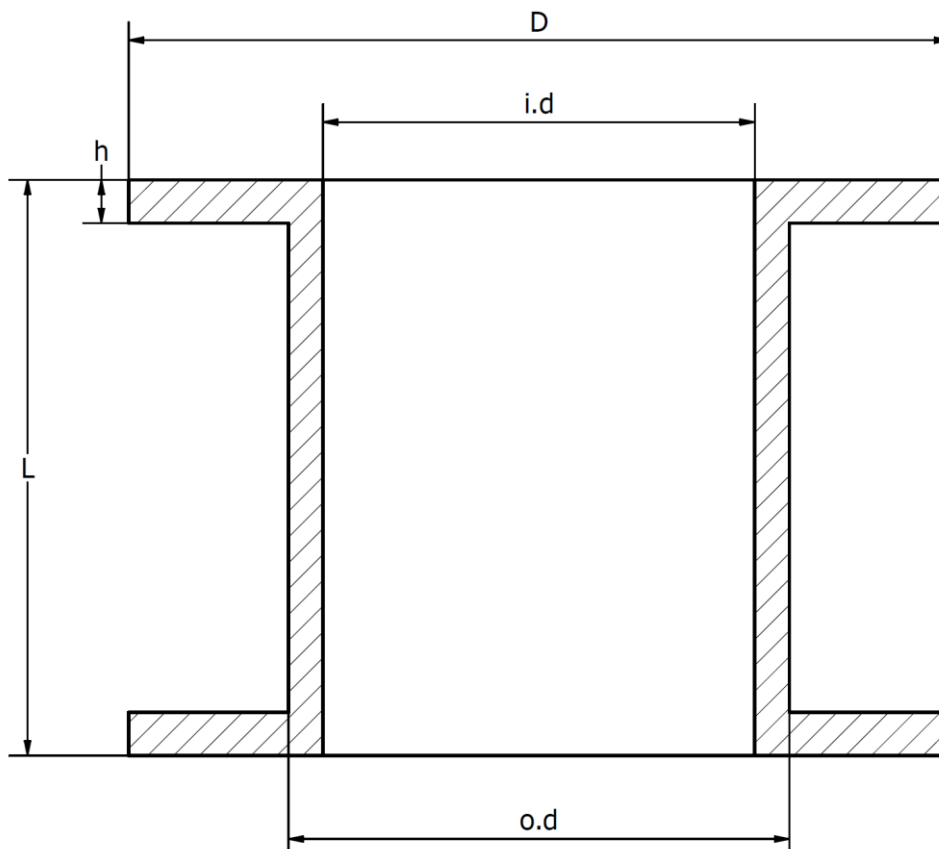







ORDER REFERENCE & DIMENSIONS

Standard measures on the below table and customized measures apply also to NBR (product code starting HLHS (D) / HLIS (S)) and EPDM hose (product code starting HLHE (D) / HLIE (S)).



Product code 	Ø i.d mm 	Ø o.d mm 	Ø D mm	h mm	L standard mm	L max. mm	Vacuum max. bar 	Weight kg/pc 
Teknikum® TITAN™ Straight Connecting hose – vacuum (NR) 								
LIR050	50	67	165	10	200	1000	0,8	0,9
LIR063	63	79	185	10	200	1000	0,8	1,1
LIR075	75	91	195	12	200	1800	0,8	1,2
LIR080	80	103	200	12	200	1000	0,8	1,5
LIR100	100	121	220	13	200	1000	0,8	1,9
LIR125	125	149	250	14	200	1900	0,8	2,6
LIR150	150	174	285	15	200	2000	0,8	3,1
LIR175	175	195	300	15	200	1000	0,8	3,5
LIR200	200	226	340	16	200	1300	0,8	4,4
LIR250	250	276	395	16	200	1300	0,8	5,5
LIR300	300	330	445	16	200	1800	0,8	7,1
LIR350	350	380	505	16	200	1400	0,8	8,9
LIR400	400	432	565	16	200	1000	0,8	11,1
LIR450	450	492	615	16	200	1200	0,8	12,0
LIR500	500	532	670	16	200	1200	0,8	13,0
LIR600	600	632	777	16	200	2000	0,8	14,0
LIR700	700	739	892	16	200	1800	0,8	15,0
LIR800	800	855	1024	16	200	1100	0,8	16,0

*Ask for more information, also other dimensions available on request.

Product code 	Ø i.d mm 	Ø o.d mm 	Ø D mm	h mm	L standard mm	L max. mm	working press. bar 	Weight kg/pc 
Teknikum® TITAN™ Straight Connecting hose – pressure (NR) 								
LHR10020	20	33	108	10	200	1000	10	0,3
LHR10025	25	40	115	10	200	1200	10	0,4
LHR10032	32	52	142	10	200	1000	10	0,6
LHR10040	40	55	152	10	200	1000	10	0,7
LHR10050	50	67	165	10	200	1000	10	0,8
LHR10063	63	79	185	10	200	1000	10	1,0
LHR10075	75	91	195	12	200	1800	10	1,3
LHR10080	80	103	200	12	200	1000	10	1,5
LHR10100	100	121	220	13	200	1000	10	1,8
LHR10125	125	149	250	14	200	1900	10	2,4
LHR10150	150	174	285	15	200	2000	10	2,8
LHR10175	175	195	300	15	200	1000	10	3,2
LHR10200	200	226	340	16	200	1300	10	4,4
LHR10250	250	276	395	16	200	1300	10	5,5
LHR10300	300	330	445	16	200	1800	10	6,8
LHR10350	350	380	505	16	200	1400	10	8,2
LHR10400	400	432	565	16	200	1000	10	9,3
LHR10450	450	492	615	16	200	1200	10	11,0
LHR10500	500	532	670	16	200	1200	10	12,1
LHR10600	600	632	777	16	200	2000	10	14,2
LHR10700	700	739	892	16	200	1800	10	16,3

*Ask for more information, also other dimensions available on request.

REFERENCE IMAGES

With recommended
Teknikum® PLUS™
flange system

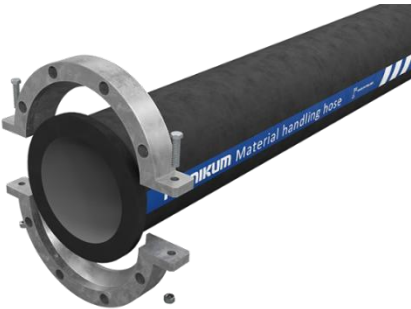

With **Teknikum® TITAN™ Select**
flange system



With **Teknikum® Support
Flange** coupling

